

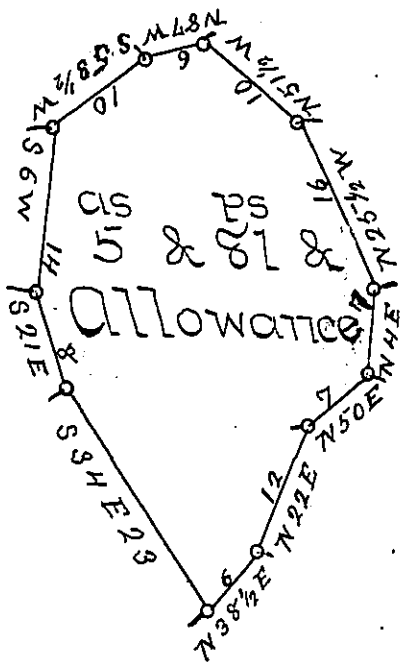

York County Shore



Lancaster County Shore

A Draught of Sheep Island situate in the River Susquehanna in Martic Township Lancaster County opposite to land of the said Joseph Reed about forty or fifty perches below Burkholders Ferry & about forty or fifty feet from the Western Shore of said river containing five acres & eighty one perches Strict Measure surveyed in pursuance of a Warrant dated the 19th day of September A.D. 1815 granted to Joseph & William Reed

pr Jacob Hibshman D.S.

To Jacob Spangler Esq }
Surveyor General. }

IN TESTIMONY that the above is a copy of the original remaining on file in the Department of Internal Affairs of Pennsylvania, made conformably to an Act of Assembly approved the 16th day of February, 1833, I have hereunto set my Hand and caused the Seal of said Department to be affixed at Harrisburg, this sixth day of June 1899.

James W. Latta
Secretary of Internal Affairs.